

SECTION 6 - LOT GRADING NEXT TO POND 3
SCALE: 1" = 10' HORIZONTAL
1" = 5' VERTICAL

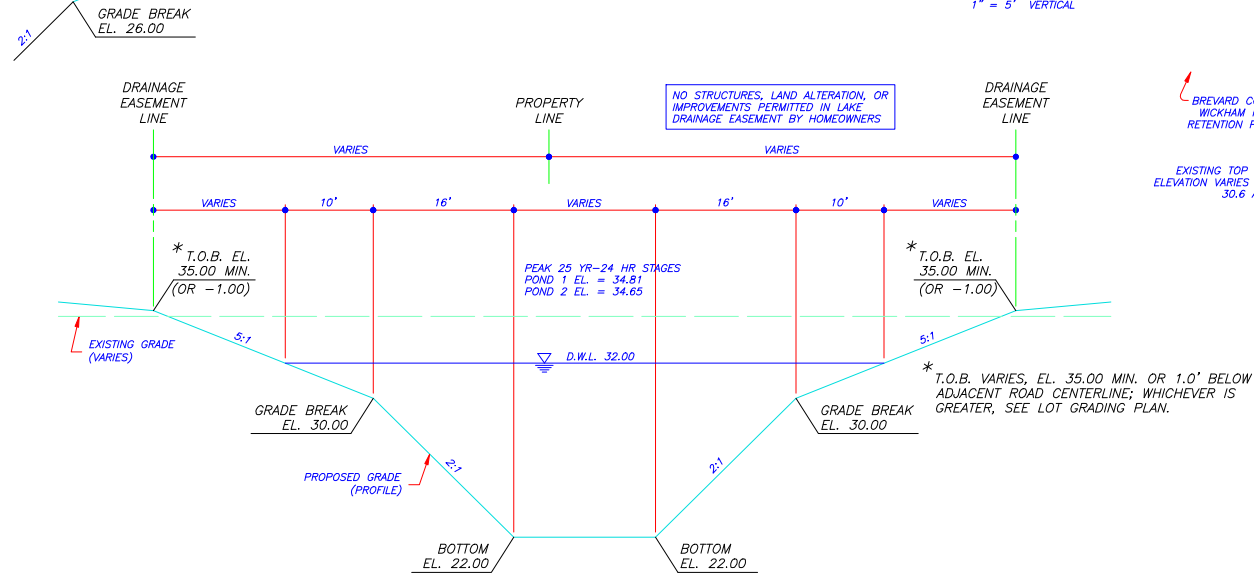

SECTION 9 - PONDS 1 & 2
SCALE: 1" = 10' HORIZONTAL
1" = 5' VERTICAL

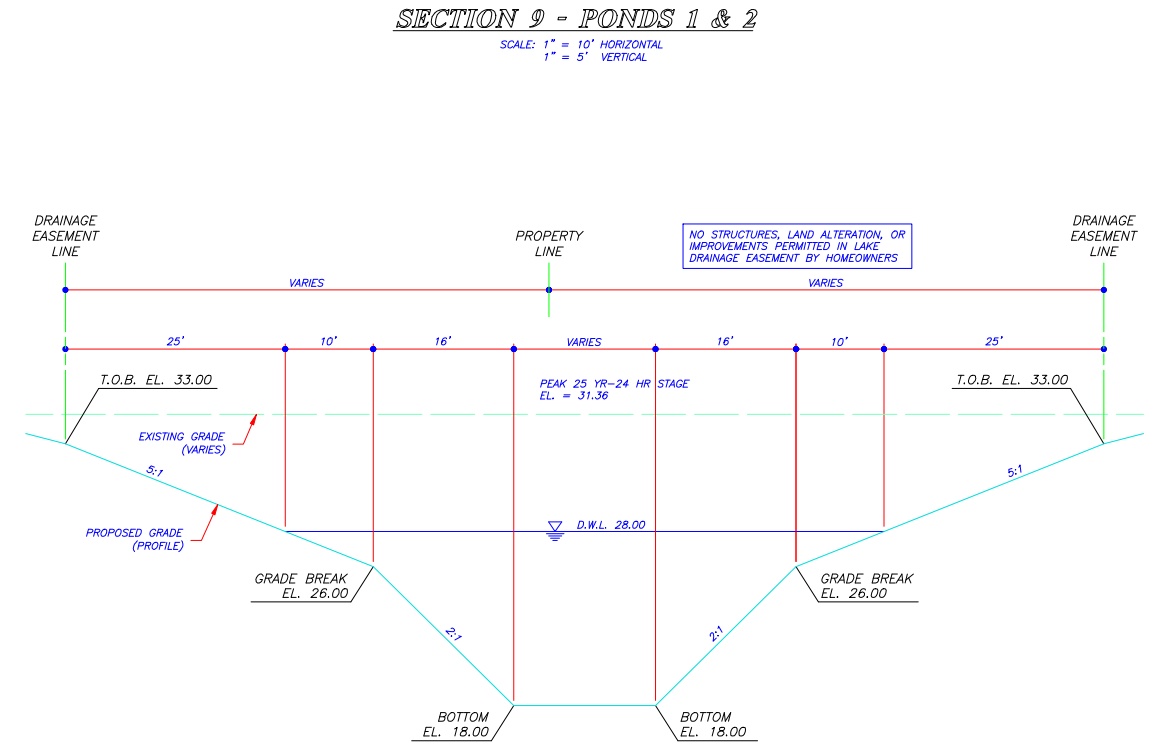

SECTION 10 - POND 3
SCALE: 1" = 10' HORIZONTAL
1" = 5' VERTICAL

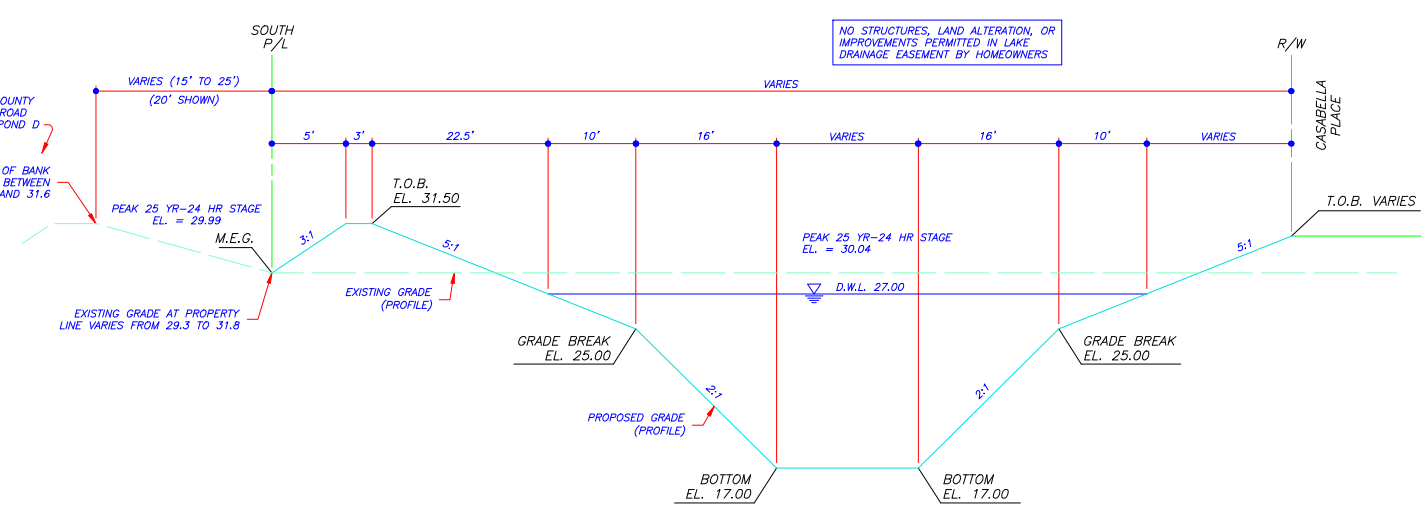

SECTION 11 - POND 4
SCALE: 1" = 10' HORIZONTAL
1" = 5' VERTICAL

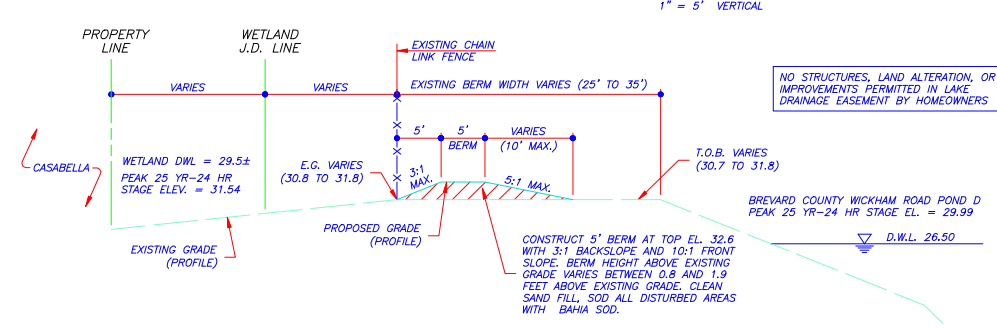

SECTION 12 - PROPOSED BERM AT POND D
SCALE: 1" = 10' HORIZONTAL
1" = 5' VERTICAL

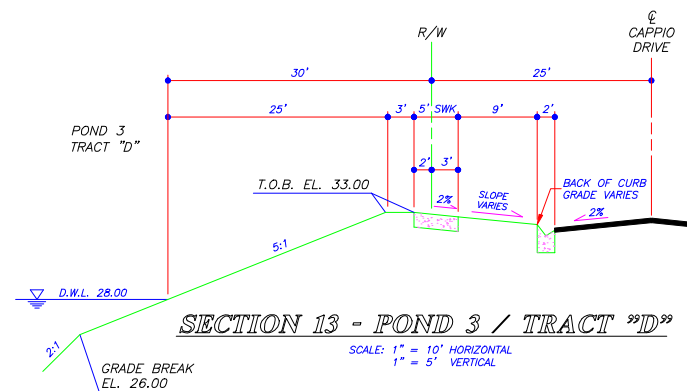

SECTION 13 - POND 3 / TRACT "D"
SCALE: 1" = 10' HORIZONTAL
1" = 5' VERTICAL

APPROVED FOR
PHASE ONE ONLY!

DATE	DESCRIPTION	BY	APP'D
04-28-01	DESIGN REVISED FOR 86 FT. LOT LAYOUT		
07-19-02	REVISED PER BREVARD COUNTY COMMENTS		
08-31-02	REVISED PER SWANSON'S COMMENTS		
09-05-02	REVISED PER COUNTY, SWANSON, & COOK'S COMMENTS		

LEE ENGINEERING, INC.
1275 South Patrick Drive, Suite H
Satellite Beach, Florida 32937
(321) 777-6270

Casabella
CROSS SECTIONS for
PONDS and LOTS

STATUS	DATE
P	PRELIMINARY
A	ISSUED FOR APPROVALS
B	BOOKING ONLY
RC	RELEASED FOR CONSTRUCTION
RD	RECORDS DWG
CK	CHECK PRINT

JOB No.: 0152-1
FILE: XSEC2-revswk
BORER: N/A
VP-1: N/A
VP-2: N/A
VP-3: N/A
VP-4: N/A
VP-5: N/A
VP-6: N/A
VP-7: N/A
VP-8: N/A
DATE: 09-01-98
SCALE: NOTED
SHEET No.:
17 of 21
ENGINEER OF RECORD